

## **PREMIUM LIST**

*For Irish Wolfhounds Only*



**Irish Wolfhound Club of Canada**  
*Presents an Irish Wolfhound only*

### ***LARGE GAZEHOUD RACING ASSOCIATION MEET***

Saturday May 26, 2018

Roll Call 10:00 am

Entry Fees:

Pre-entries: \$15.00 per hound

Gate entries on day of Meet: \$20.00 per hound

FTE Entries: additional \$2.00 plus copy of Canadian or American registration

***PRE-ENTRIES CLOSING DAY MAY 19, 2018***  
***GATE ENTRIES ON DAY OF EVENT***

#### ***RACE SECRETARY***

Jocelyne M. Gagné

128 Pearson Road, Welland, ON L3B 5N4

Home: 905-788-3708 Cell: 905-988-0247

Email: [starkeeperiw@gmail.com](mailto:starkeeperiw@gmail.com)

#### **TATTLETALE FARM**

**Princeton, Ontario (near Woodstock), Canada**

#### ***IMPORTANT NOTICE***

In order to run a race meet of this type, it is imperative that all owners pitch in to help. That means having a place to contain your Wolfhound when he is not running so that you can help with the other races. We'll need volunteers to walk hounds to the starting line and to line/foul judge.

## IRISH WOLFHOUND CLUB OF CANADA

President.....Jocelyne Gagné  
Vice-Presidents..... Guylaine Gagnon ,Kathie Upton, Katy Albrecht  
Secretary:..... Louise Bouchard-Laird  
Treasurer..... Judith Callender  
Directors:..... Jill Benoit, Fran Briscoe, Suzan Humphreys, Emma Ross, Donna Tomson  
LGRA Delegate..... Jocelyne Gagné

### **WHAT IS LGRA?**

LGRA is sprint racing for Gazeounds. The hounds run 200 yards straight after a lure consisting of a fur bag and squawker. Up to four hounds race a total of three times, called programs. Depending on the order of finish, they may attain national points towards a GRC (Gazehound Race Champion) title. Hounds will be hand slipped. More information can be found at [www.lgra.org](http://www.lgra.org)

Hounds need to be one year of age or older to be entered. They will also need to be registered with LGRA. This can be done the first time the hound is raced by including a photocopy of the hound's registration papers (either Canadian or American) with the entry. After registration, your hound will receive an LGRA number that will be used in entering future LGRA meets.

**HOUNDS WILL NOT BE ALLOWED TO ENTER WITHOUT A COPY OF PROPER REGISTRATION AT THE TIME OF ENTRY. NO EXCEPTIONS WILL BE ALLOWED.**

All hounds will run muzzled to prevent damage to the squawker. It is recommended that hounds be accustomed to a muzzle before the event. A limited supply of racing muzzles will be available for use so please bring your own if possible. Numbered racing blankets will also be available. Bitches in season are not allowed to compete.

Previous experience is not required. Time allowing, several practice runs will be held for new hounds.

Dogs five (5) years of age or older are considered Veterans for Straight racing.

Try it and see – your hound may surprise you!

### **ENTRY FEES**

The entry fee for each hound will be \$15 if the entry/email is received by the Race Secretary by May 19, 2018. Entries will be accepted after May 19 and on the day of the event, at a gate entry fee of \$20 per hound. First time entries must include an additional \$2 and a copy of registration certificate.

Payment may be made by PayPal to [jivanovs@vaxxine.com](mailto:jivanovs@vaxxine.com) for Email entries. Please add \$1.00 per entry for Paypal .

For mail entries, make cheques payable to the IWCC and send to:

**IWCC RACE SECRETARY**  
**Jocelyne M. Gagné**  
**128 Pearson Road, Welland, ON L3B 5N4**

Home: 905-788-3708  
Email: [starkeeperiw@gmail.com](mailto:starkeeperiw@gmail.com)

**ALL HOUNDS WILL BE HAND SLIPPED AT THE START.**

**Irish Wolfhound Club of Canada IW Only Race Meet May 26, 2018**

***Large Gazehound Racing Association***

Pre-entry fee: \$15 per hound  
Gate entry fee: \$20 per hound  
First Time Entered: \$2.00  
PayPal/Bank Transfer: \$1.00  
**jivanovs@vaxxine.com**

**For hounds with LGRA Number – Quick Entry**

---

Breed: Irish Wolfhound                      Call Name: \_\_\_\_\_

LGRA Number: \_\_\_\_\_      First Time Entered? \_\_\_\_\_

Date Whelped: \_\_\_\_\_                      Sex: Dog or Bitch

Indicate if: Canadian Conformation Champion.      Yes/No  
                  Canadian Lure Coursing Champion      Yes/No  
                  Veteran (Over 5 years)                      Yes/No

---

Breed: Irish Wolfhound                      Call Name: \_\_\_\_\_

LGRA Number: \_\_\_\_\_      First Time Entered? \_\_\_\_\_

Date Whelped: \_\_\_\_\_                      Sex: Dog or Bitch

Indicate if: Canadian Conformation Champion.      Yes/No  
                  Canadian Lure Coursing Champion      Yes/No  
                  Veteran (Over 5 years)                      Yes/No

---

**For First Time Entered Hounds with NO LGRA Number**

Breed: Irish Wolfhound                      Call Name: \_\_\_\_\_

Registered Name: \_\_\_\_\_

Date Whelped: \_\_\_\_\_                      Sex: Dog or Bitch

First Time Entered? YES **(Please include copy of registration- either AKC or CKC)**

Indicate if: Canadian Conformation Champion.      Yes/No  
                  Canadian Lure Coursing Champion      Yes/No  
                  Veteran (Over 5 years)                      Yes/No

Name of Owner: \_\_\_\_\_

Address: \_\_\_\_\_                      Postal Code/Zip Code: \_\_\_\_\_

---

I and my heirs, legal representatives and assigns, shall hold harmless and defend the IWCC, its officers, directors, and agents, from a claim for personal injury, illness or property damage arising out of participation in this event. I agree to abide by the rules and regulations of the Large Gazehound Racing Association and its code of conduct during this race meeting.

Signature of Owner: \_\_\_\_\_

Telephone: \_\_\_\_\_

E-mail Address: \_\_\_\_\_

## AWARDS & TROPHIES

**Thank you to Jocelyne Gagne Trophy Chair for this meet.** Trophies and Ribbons will be awarded at this LGRA Race Meet for the following placements:

**High Score  
High Score Opposite Sex  
Top Five Racers  
High Score Coursing Champion  
High Score Show Champion  
High Score First Time Entered  
High Score Veteran (5 yrs +)  
Turtle Award  
Ribbons for all placements**

Donations still needed and gratefully accepted. If you would like to contribute please contact

**Jocelyne 905-788-3708**

**OR** mail your cheque to Jocelyne, 128 Pearson Rd, Welland, L3B 5N4

**OR** include the donation with your entry payment to the Race Secretary.

---

### Directions to Site

**From Toronto:** Hwy 401 to Oxford Rd 29 (Exit 250). Left over the 401, right on Gobles Rd (first (road)). Right on Twp Rd 3, 1<sup>st</sup> farm on right.

**From London:** Hwy 401 to Hwy 2 East. Hwy 2 to Gobles, turn left on Gobles Rd (beside gas station) to Twp Rd 3, turn left, 1<sup>st</sup> farm on right.

**From Hamilton/Niagara:** Hwy 403 to Brant Rd 25, north (right) on Brant Rd 25 to Hwy 2 (stop sign). Left on Hwy 2 to Gobles, turn right on Gobles Rd (beside gas station) to Twp Rd 3, turn left, 1<sup>st</sup> farm on right.

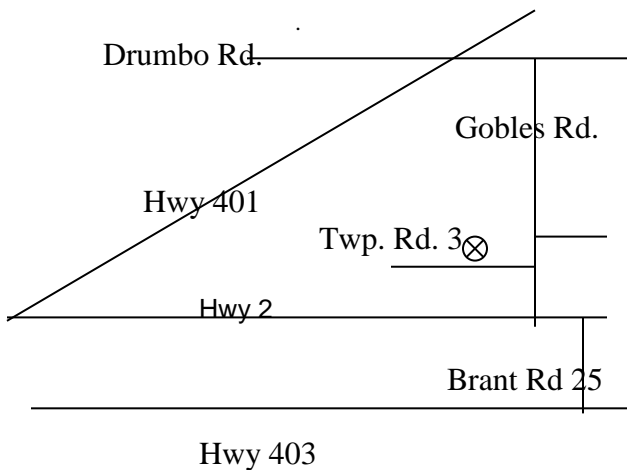

**EXHIBITORS ARE ASKED TO KEEP SICK HOUNDS AT HOME.**

Race Committee Members: Jocelyne Gagne, Lani Hopf, Celeste Atkinson, Lynnie Tolton, Karin Eder